

Congratulations!

Congratulations on your purchase of 20X30 Event Tent by Canopymart.com. With Proper installation, use, and maintenance, your new unit will provide many years of good and suitable service. Your New 20X30 Event Tent Party Tent is a combination of excellent engineering and well thought out design. The unit is comprised of a rigid tubular frame, covered with a long life polyester cover.

The Multiple part frame is easy insertion of hardware to assemble. The tubing is made from high grade galvanized steel tubing, to resist moisture and oxidation over the life of the canopy. The covering membrane is compliance with Fire Marshall Code CPA184-7 The Cover is UV protected for continual exposure to the sunlight.

It is suggested that you read the assembly instructions completely before you begin. This will help attain the best results for your installation the first time.

SAFETY WARNING

The installation of this unit must conform to the requirements of all authorities having jurisdiction in your specific local area. In the absence of such requirements, the installation must conform to the provided assembly and installation instructions.

Canopymart.com will not be responsible for failure to comply with any requirements in a given local area.

Consequential damages or injuries caused by improper installation, alteration, or improper use are strictly that of the user. Unit **MUST** be cleared of All Snow Accumulation immediately to avoid overload. Unit is not to be used for occupancy for any length of time. NO running internal combustion engines, open flames, or contact with heated surfaces are allowed.

For installation assistance or Customer Services, Please call 800-896-2008 or 714-522-3202, 8AM-5PM PST. Cartons should be inspected upon delivery from carrier, and any evident damages should be noted on the bill of lading before signing. If upon opening the cartons hidden damage is noted, contact carrier or its agent immediately, Claims for shipping damage **MUST** be made with the shipping company. An inspection of the goods will most likely be required. Do not discard packing or any components before the freight company's inspection. All claims for freight damage must be made with 15 days of receipt of the goods in accordance with ICC regulations.

Assembly Procedure

The Proper sequence and steps to install this unit will produce proper and good installation. Failure to read and follow these guidelines may result in an improper installation and will void all warranty and protection the owner is entitled to with the product. The steps to be undertaken are:

1. Perform an inventory check before beginning to be certain all components are available for installation.
2. Prepare location and place all the boxes near location sight.
3. Assemble (B)&(C) Pipes and (B)&(D) Pipes with 2 Way Fitting Connector to make Longer Length.
4. Insert above Pipes(10pcs) to 6 Way Top Top Center(G) Fitting(2Pcs).
5. Insert 4Way Corner(E) and 4Way Side(F) fitting with (A) and (E)Pipes and above top frame.
6. Install main cover over top frame assembly.
7. Tie inside cover with Velcro and ball ties down.
8. Insert (B) Pipes(10pcs) under above top frame
9. Install Sides and Front&Back Panel to the frame.
10. Tie indise cover with Velcro and ball ties down.
11. Install Bar Brace(22pcs) to any corner of inside frame.

Inventory Check

Start installation procedure by removing all components from packaging and ensure all components are present

| Qty | Ltr | Part No. | Description |
|-----|-----|----------|----------------------------|
| 8 | A | SSPE910 | 9ft 10inch Long Pipe (Red) |
| 20 | B | SSPE8 | 8ft Long Pipe (Blue) |
| 4 | C | SSPE6938 | 6ft 9 3/8inch Pipe (Green) |
| 6 | D | SSPE3214 | 3ft 2 1/4inch Pipe (White) |
| 3 | E | SSPE96 | 9ft 6inch Pipe (Yellow) |
| 4 | F | FWFC4HC | 4 Way Conner Fitting |
| 6 | G | FW4ICST | 4 Way Side Fitting |
| 2 | H | FWCR6 | 6 WAY Top Center |
| 10 | I | FWFCL | 2 Way Connector Fitting |
| 1 | J | TOC2030 | 20X30 TOP COVER |
| 70 | M | MBBLR | 11inch Long Ball Tie Down |
| 12 | N | FWBB40 | 40inch Long Bar Brace |

Frame Diagram

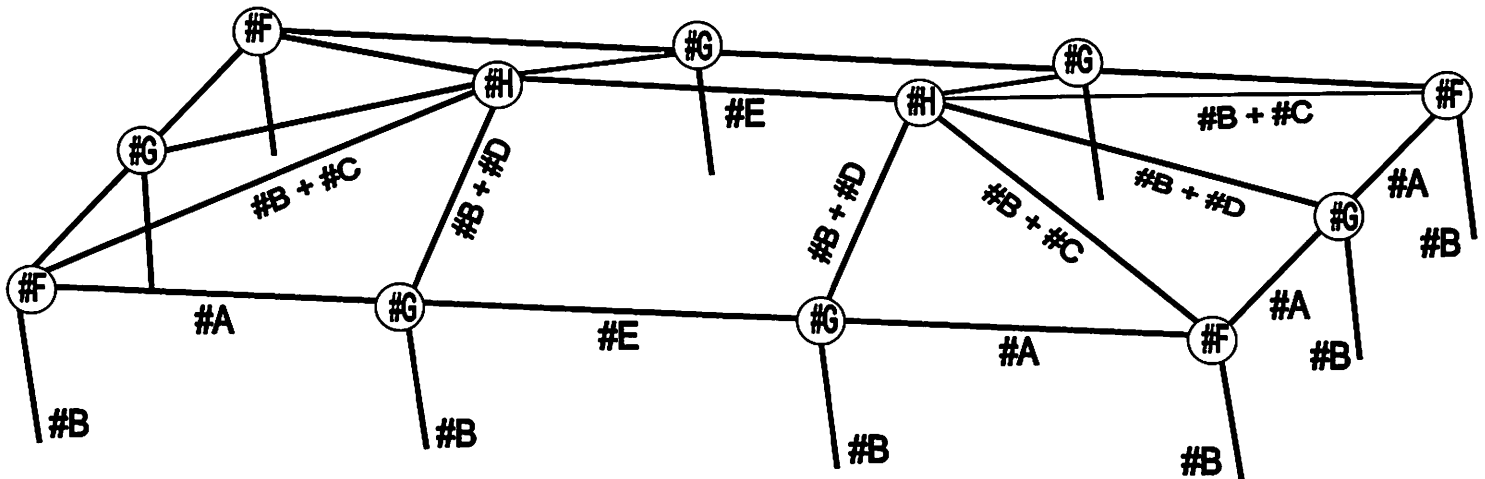

Site Preparation

Select a level or as close to level as practical location for your 20 X 30 Luxury Event Party Tent. The Unit should be placed on a base of materials suitable for the storage load to be protected. The Unit should not be located under trees, which will shed hard fruit such as apples, walnuts, or heavy pine cones. The cover of your unit will protect against normally leaves and light debris, however large branches or other falling items may cause puncture or tears in the cover material.

Take notice of drainage around your intended location. Water draining from the surrounding terrain should be planned so that it does not run into the unit. As well, rain or melting snow that comes off the unit should be drained away rather than accumulate and pool around the unit.

Frame Assembly

Step1.

Assemble the two (B)&(C) Pipes and (B)&(D) Pipes with 2 Way Connector Fitting to make Longer Length of pipe.

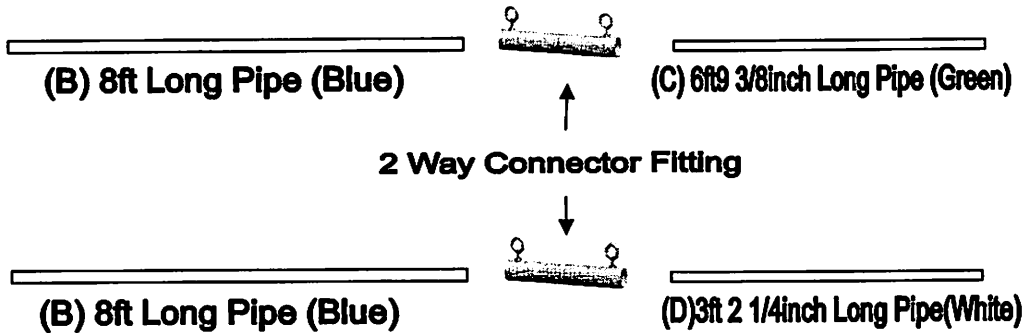

Step2.

Insert Step1. Pipes(10pcs) to 6 Way Top Center(G) Fitting(2pcs).

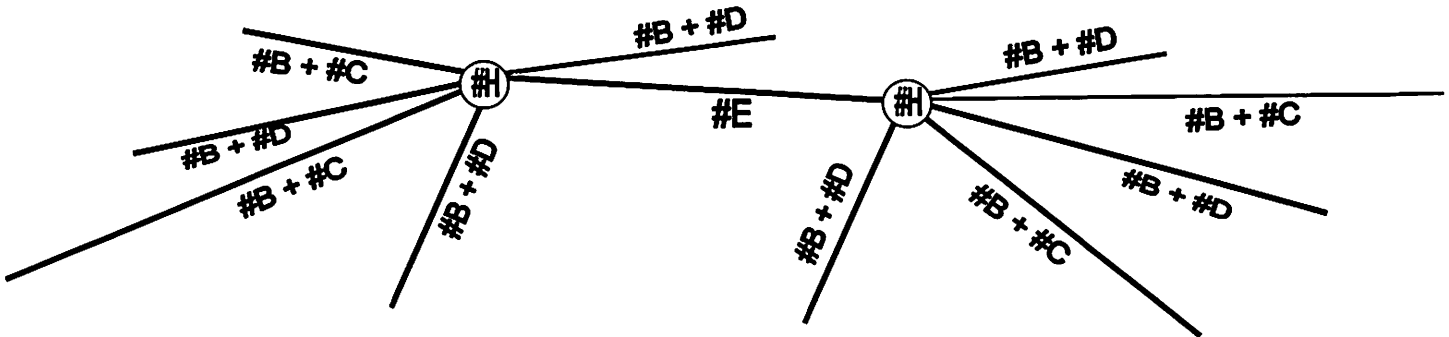

Step3.

Insert 4Way Corner(F) and 4Way Side(G) fitting with (A) and (E) Pipes and above top frame.

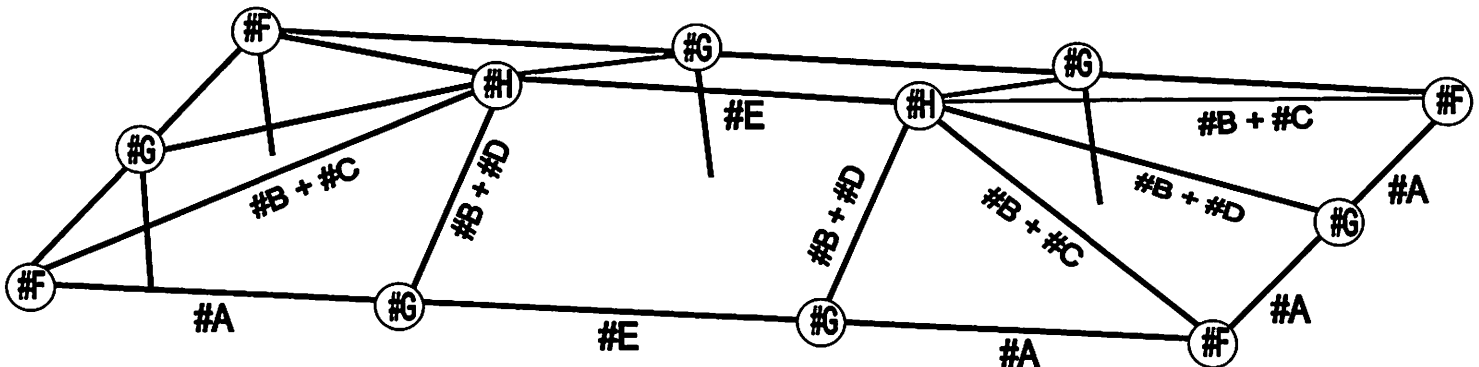

Frame Assembly

Step4.
Install main cover over top frame assembly.

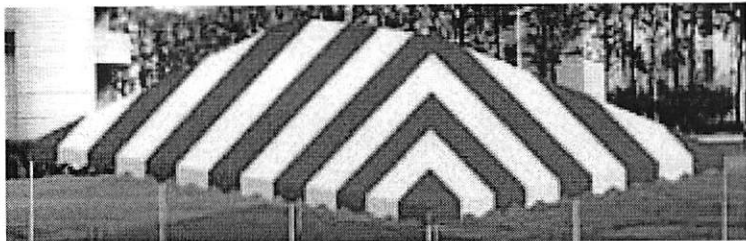

Step5.
Tie inside cover with velcro and ball tie down.

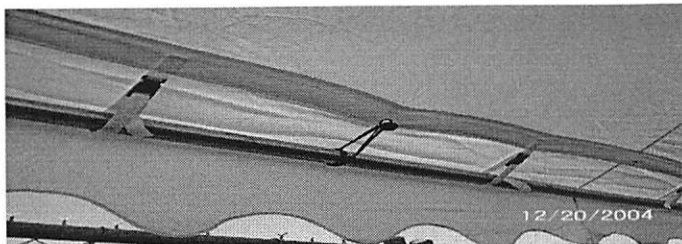

Step6.
Insert (B) Pipes(10pcs) under above top frame.

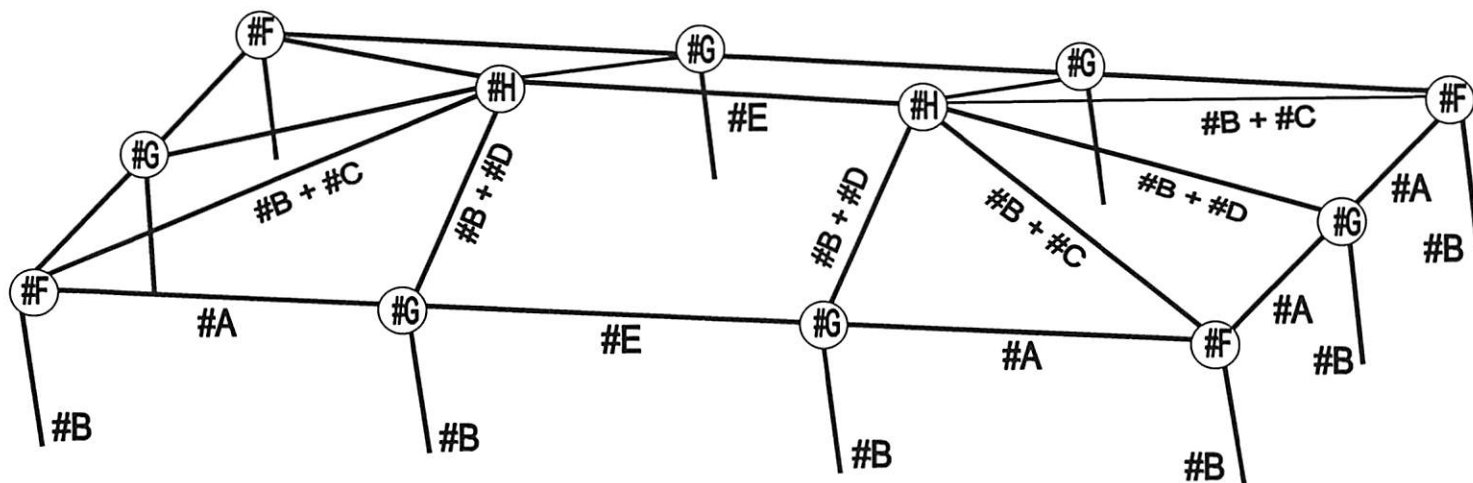

Step7.
Install Bar Brace(12pcs) to any corner of inside frame.

